

RIDGE 2x6 IS 42" LONG  
WITH ENDS TAPERING 1"  
FROM TOP TO BOTTOM

CUT 30° BEVEL  
ON 2x2

DECORATIVE  
MOLDING

NOTCH POST  
TO ACCEPT  
2x6

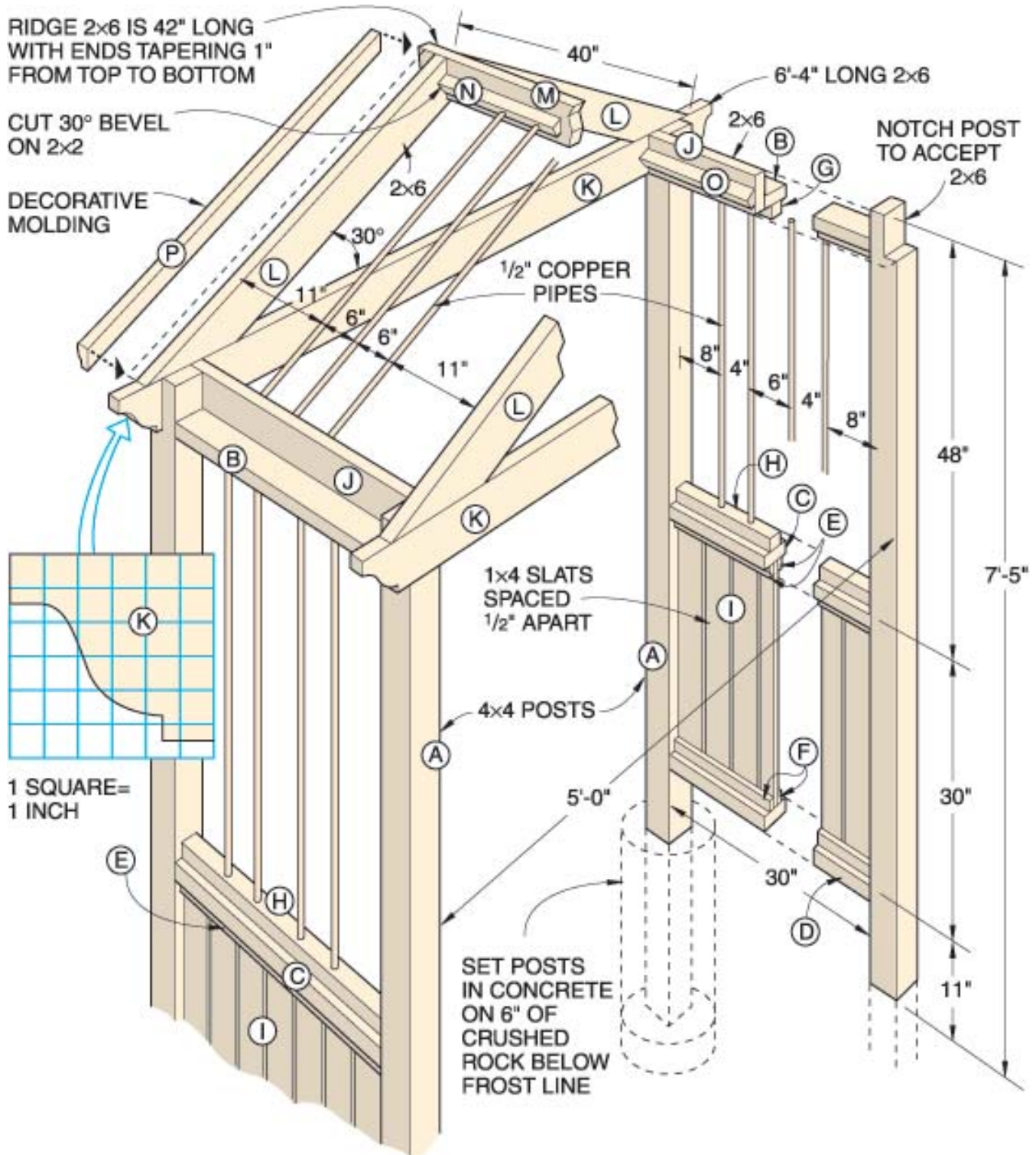

1 SQUARE=  
1 INCH

SET POSTS  
IN CONCRETE  
ON 6" OF  
CRUSHED  
ROCK BELOW  
FROST LINE